

## SOT-23 Plastic-Encapsulate Diodes

### BAS70/-04/-05/-06 SCHOKKTY BARRIER DIODE

#### FEATURES

- Low turn-on voltage
- Fast switching
- Also available in lead free version

SOT-23

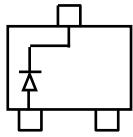
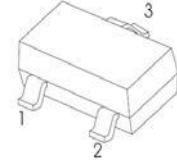

BAS70 Marking: 73

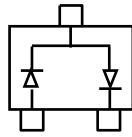

BAS70-04 Marking: 74

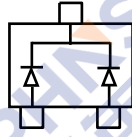

BAS70-05 Marking: 75

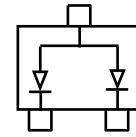

BAS70-06 Marking: 76

#### MARKING:

BAS70

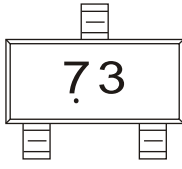

BAS70-04

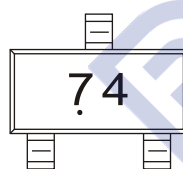

BAS70-05

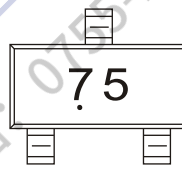

BAS70-06

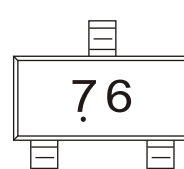

Solid dot = Green molding compound device.

#### MAXIMUM RATINGS @T a=25°C

| Symbol          | Parameter   | Value      | Unit |
|-----------------|---|------------|------|
| $V_R$           | DC Voltage  | 70         | V    |
| $I_F$           | Forward Continuous Current                            | 70         | mA   |
| $I_{FSM}$       | Non-Repetitive Peak Forward Surge Current @ t = 8.3ms | 100        | mA   |
| $P_D$           | Power Dissipation                                     | 200        | mW   |
| $R_{\theta JA}$ | Thermal Resistance Junction to Ambient                | 500        | °C/W |
| $T_J$           | Operating Junction Temperature Range                  | -40 ~ +125 | °C   |
| $T_{stg}$       | Storage Temperature Range                             | -55 ~ +150 | °C   |

#### ELECTRICAL CHARACTERISTICS (Ta=25°C unless otherwise specified)

| Parameter                       | Symbol     | Test conditions   | Min | Max         | Unit |
|---------------------------------|------------|---|-----|-------------|------|
| Reverse breakdown voltage       | $V_{(BR)}$ | $I_R = 10\mu A$   | 70  |             | V    |
| Reverse voltage leakage current | $I_R$      | $V_R = 50V$   |     | 100         | nA   |
| Forward voltage                 | $V_F$      | $I_F = 1mA$<br>$I_F = 15mA$                               |     | 410<br>1000 | mV   |
| Diode capacitance               | $C_D$      | $V_R = 0V$ f=1MHz   |     | 2           | pF   |
| Reverse recovery time           | $t_{rr}$   | $I_F = I_R = 10mA, I_{rr} = 0.1I_R,$<br>$R_L = 100\Omega$ |     | 5           | ns   |

# Typical Characteristics

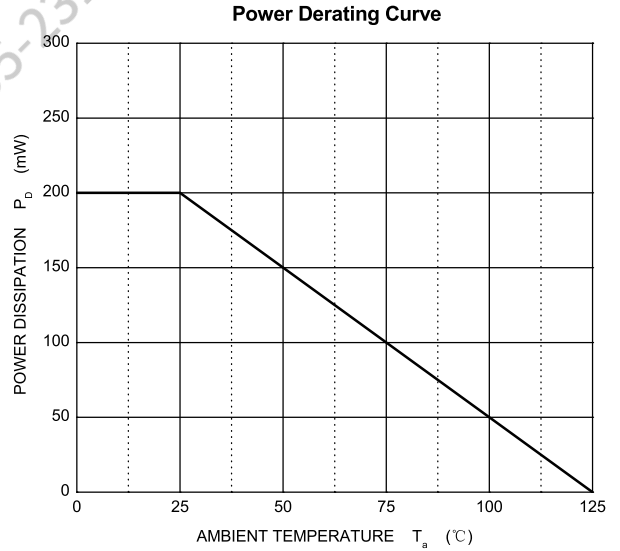
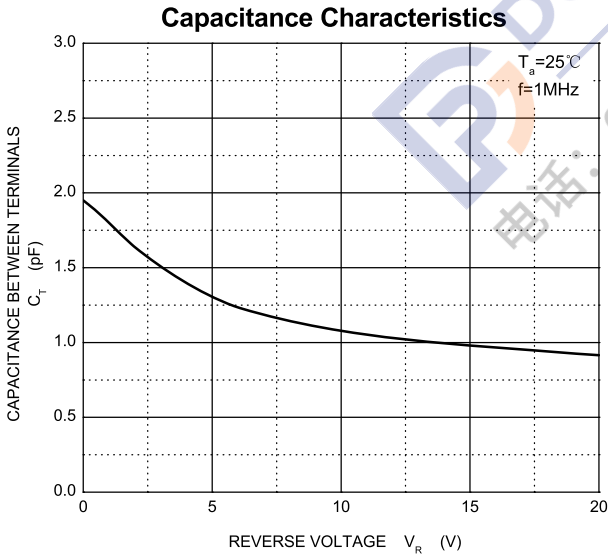
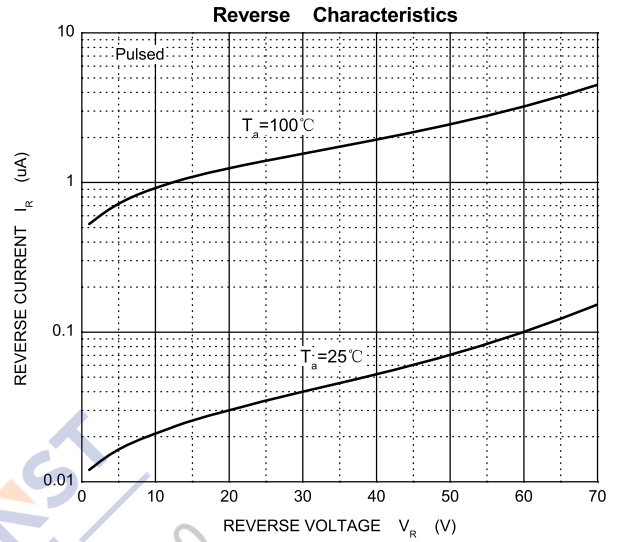
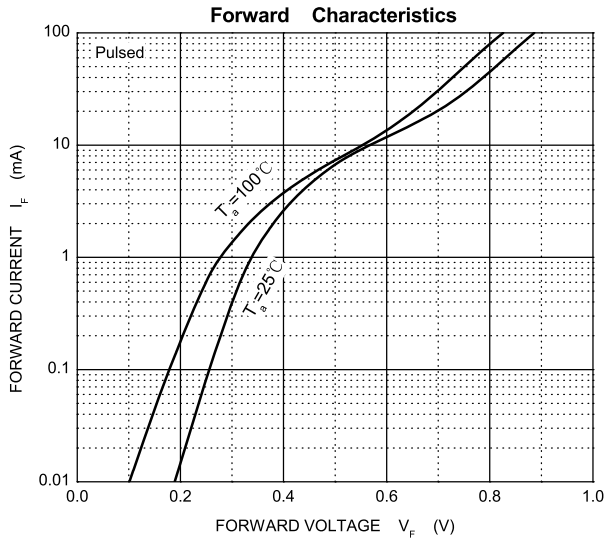

## SOT-23 Package Outline Dimensions

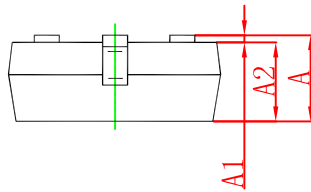
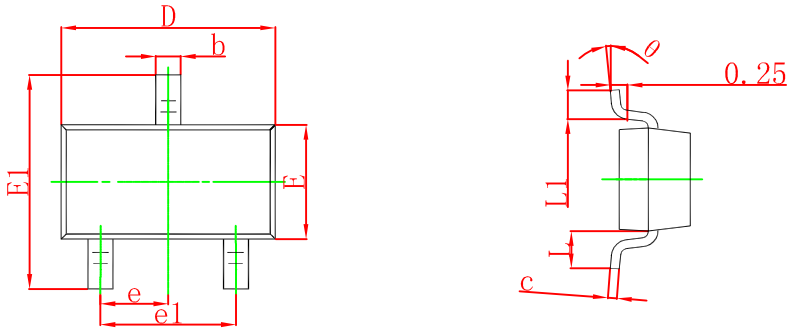

| Symbol | Dimensions In Millimeters |       | Dimensions In Inches |       |
|--------|---------------------------|-------|----------------------|-------|
|        | Min                       | Max   | Min                  | Max   |
| A      | 0.900                     | 1.150 | 0.035                | 0.045 |
| A1     | 0.000                     | 0.100 | 0.000                | 0.004 |
| A2     | 0.900                     | 1.050 | 0.035                | 0.041 |
| b      | 0.300                     | 0.500 | 0.012                | 0.020 |
| c      | 0.080                     | 0.150 | 0.003                | 0.006 |
| D      | 2.800                     | 3.000 | 0.110                | 0.118 |
| E      | 1.200                     | 1.400 | 0.047                | 0.055 |
| E1     | 2.250                     | 2.550 | 0.089                | 0.100 |
| e      | 0.950 TYP                 |       | 0.037 TYP            |       |
| e1     | 1.800                     | 2.000 | 0.071                | 0.079 |
| L      | 0.550 REF                 |       | 0.022 REF            |       |
| L1     | 0.300                     | 0.500 | 0.012                | 0.020 |
| θ      | 0°                        | 8°    | 0°                   | 8°    |

## SOT-23 Suggested Pad Layout

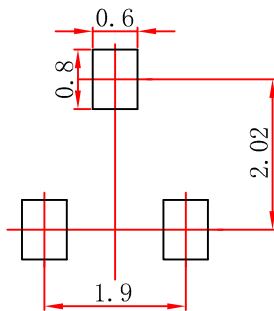

### Note:

1. Controlling dimension: in millimeters.
2. General tolerance:  $\pm 0.05\text{mm}$ .
3. The pad layout is for reference purposes only.

### NOTICE

JSCJ reserves the right to make modifications, enhancements, improvements, corrections or other changes without further notice to any product herein. JSCJ does not assume any liability arising out of the application or use of any product described herein.

# SOT-23 Tape and Reel

## SOT-23 Embossed Carrier Tape

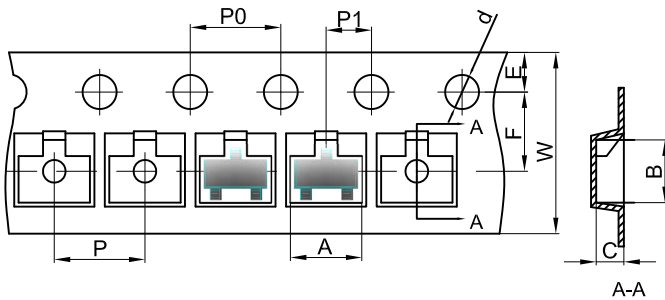

### Packaging Description:

SOT-23 parts are shipped in tape. The carrier tape is made from a dissipative (carbon filled) polycarbonate resin. The cover tape is a multilayer film (Heat Activated Adhesive in nature) primarily composed of polyester film, adhesive layer, sealant, and anti-static sprayed agent. These reeled parts in standard option are shipped with 3,000 units per 7" or 17,8cm diameter reel. The reels are clear in color and is made of polystyrene plastic (anti-static coated).

Dimensions are in millimeter

| Pkg type | A    | B    | C    | d     | E    | F    | P0   | P    | P1   | W    |
|----------|------|------|------|-------|------|------|------|------|------|------|
| SOT-23   | 3.15 | 2.77 | 1.22 | Ø1.50 | 1.75 | 3.50 | 4.00 | 4.00 | 2.00 | 8.00 |

## SOT-23 Tape Leader and Trailer

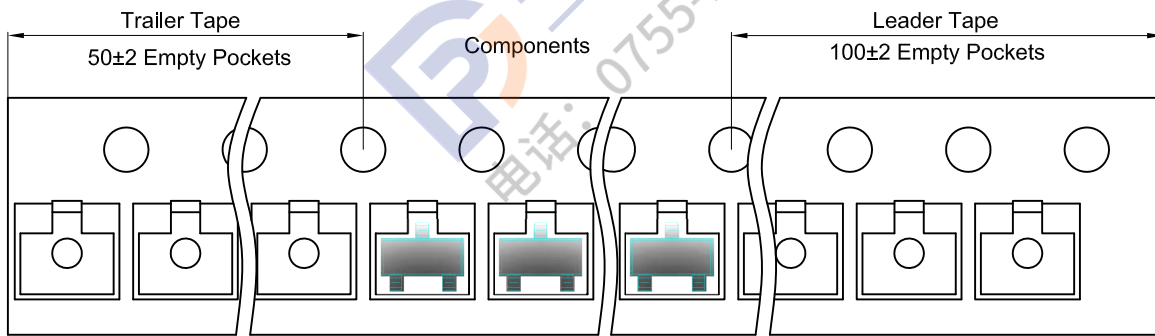

## SOT-23 Reel

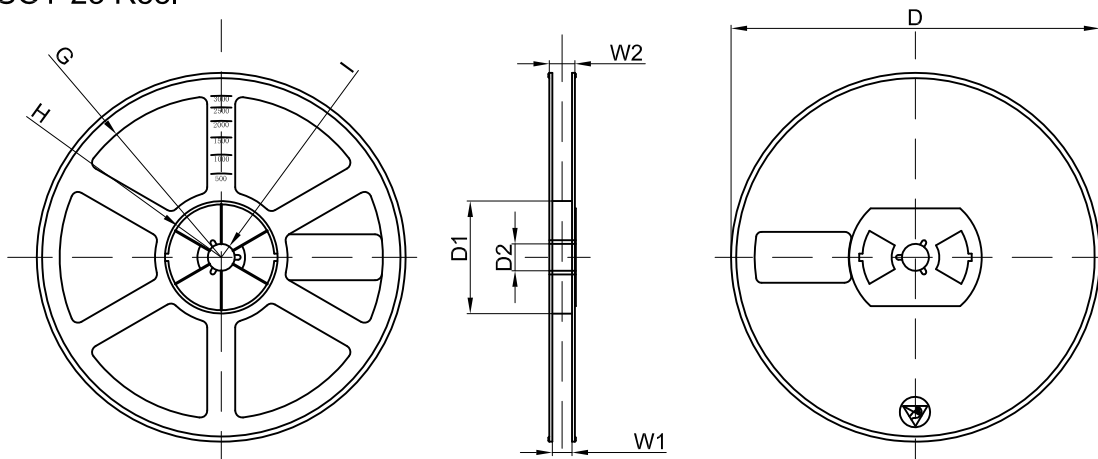

Dimensions are in millimeter

| Reel Option | D       | D1    | D2    | G      | H      | I     | W1   | W2    |
|-------------|---------|-------|-------|--------|--------|-------|------|-------|
| 7" Dia      | Ø178.00 | 54.40 | 13.00 | R78.00 | R25.60 | R6.50 | 9.50 | 12.30 |

| REEL     | Reel Size | Box        | Box Size(mm) | Carton      | Carton Size(mm) | G.W.(kg) |
|----------|-----------|------------|--------------|-------------|-----------------|----------|
| 3000 pcs | 7 inch    | 45,000 pcs | 203×203×195  | 180,000 pcs | 438×438×220     |          |